



Operation manual for models:

دليل المستخدم للنماذج:

Manuel d'utilisation pour les modèles:

Benutzerhandbuch für Modelle:

Εγχειρίδιο χρήστη για μοντέλα:

Manual de usuario para modelos:

H045SM, H053SM, H070SM, H080SM, H100SM



Two Year Limited Warranty

This limited warranty covers all defects in materials only and/or workmanship only.

If a structural or mechanical defect occurs during the warranty period, ExecutiveSafe Company Limited or its designee (hereafter "ExecutiveSafe") will repair or replace the defective part(s) of the Product or Product, at its sole option, at no charge. You may have certain rights under your local law.

Nothing in these terms is intended to affect those rights, if they are applicable.

Warranty Service

To obtain Warranty service contact your local ExecutiveSafe office with your name address, and proof of purchase - original sales receipt is required with no exception (**store your sales receipt in the safe**) and with a brief description of the problem.

DO NOT SEND YOUR DEFECTIVE PRODUCT BACK TO EXECUTIVESAFE.



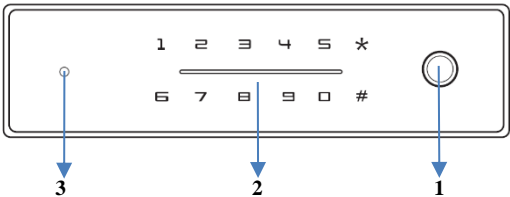

Limitations of warranty

1. ExecutiveSafe's responsibility and the buyer's exclusive remedy under this warranty are limited to the repair or replacement of the defective part(s) of the Product or Product, at ExecutiveSafe's sole option. In no event shall ExecutiveSafe be liable for loss or damage due to external events such as theft, fire, water, earthquake, or vandalism or for any incidental or consequential damages to persons or property (including the contents of the Product) resulting from the breach of this or any other expressed or implied warranty applicable to the Product.
2. Except as may be otherwise provided by applicable law, ExecutiveSafe disclaims any and all other covenants and warranties, whether written or oral, expressed or implied, including, but not limited to, the implied warranties of merchantability, satisfactory quality, fitness for a particular purpose, workmanlike effort, and non-infringement.
3. ExecutiveSafe is not responsible for damage, defects, or malfunction to the Product caused by shipment.
4. This Limited Warranty does not cover defects, damage, or malfunction caused by alteration, modification, service or repair of the Product by anyone other than ExecutiveSafe, or caused by misuse of the product or physical abuse to the product.
5. This Limited Warranty does not cover normal wear, battery replacement or periodic maintenance.

Before using the safe, we strongly advise reading the entire manual.



1. Fingerprint Scanner 2. Touch Screen Digital Keypad 3. Socket for Auxiliary Power

Picture	Item Name	Quantity Supplied	Remarks
	Override Key	2	Opens the safe manually
	AA, Alkaline Batteries	4	Needed to operate the safe
	Auxiliary Battery Pack	1	For external power if needed
	Operation Manual	1	Read before start using the safe
	Expansion Screws	2	Bolt the safe to a wall

Using the Override Key to Open the Safe

Using your finger, push and turn the override key cover to come out to reveal the key lock, located at the front of the door, see Fig. 1, Insert the override key and turn it clockwise until it stops and hold it.

Push the knob to pop out of its place and turn it clockwise (right) to open the door.

Turn the key counterclockwise (right) to remove it and place back the override key cover.



Fig. 1

NOTE: DO NOT STORE THE OVERRIDE KEY IN YOUR SAFE!

Please secure your override keys in a safe place. If the override keys are lost or damaged, contact your local ExecutiveSafe office.

Battery Installation

Four alkaline AA batteries (**included**) are required.

NOTE: Non-alkaline or rechargeable batteries ARE NOT RECOMMENDED.

To install the batteries, slide the battery cover to the right, located on the inside back side of the door. See Fig. 2. Insert the four batteries as indicated. Insert back the battery cover.

NOTE: Batteries should be replaced:

1. If the Voice Response Prompts: “Low Voltage”
2. If the indicator light along the middle of the keypad turns yellow going from left to right (water flow direction)
3. If a low-battery alarm message is received on a paired mobile device.



Fig. 2

Auxiliary Battery Pack

If the batteries installed in the safe run out of power, the Auxiliary Battery Pack (included) can be utilized as a temporary power source.

Install 4 (AA size) alkaline batteries in the auxiliary battery pack. Note the polarity (+/-) markings in the battery compartment to ensure proper installation.

Plug in the auxiliary battery pack, in the socket located on the touch panel, as indicated in the below figure. Open the safe as usual and replace the batteries of the safe.



Turning the Interactive Voice Response ON & OFF

1. With the safe door open and the touch screen not illuminated (sleep mode), press and release the “SET” button inside the battery compartment at the back of the door (see Fig. 3).
2. The Interactive Voice Response will prompt: "Please enter your fingerprint or password." The LED indicator light will turn fully white.
3. Press 7#
4. The Interactive Voice Response will turn OFF/ON

Note: The interactive Voice Response is always on during programming and setting up the safe.

Alarm Function

Note: For the alarm to be activated, the alarm function must be set every time the safe is locked. In case the alarm function is not set and the safe is moved or jarred or an attempted forced entry occurs the alarm will not be activated.

To set the alarm function, close the door, and make sure the safe is in sleep mode, touch the screen to light up and touch the “0” and then “#” buttons, the green indicator LED light will light from the left to right (water flow direction), indicating that the alarm has been activated.

If the alarm function is set and the safe experiences vibration, the alarm will be activated for 30 seconds.

The alarm can be deactivated by entering the correct fingerprint or by touching the screen to light up and entering the correct combination followed by the “#” button.

Lockout Function

If the wrong combination is entered three consecutive times or the wrong fingerprint is entered five consecutive times, the red indicator LED light will light from left to right (water flow direction) each time the wrong combination is entered, and at the last incorrect entry, the alarm will be activated for 30 seconds. The keypad and the finger recognition scanner will enter a 3-minute lockout period. During this period the keypad and the finger recognition scanner will be disabled. After the 3-minute lock-out period, the keypad and the finger recognition will become active again.

The alarm can be deactivated by entering the correct fingerprint or by touching the screen to light up and entering the correct combination followed by the “#” button.

Opening and Closing the Safe

Opening the Safe Using the Keypad:

In the sleep mode, touch the screen anywhere for the keypad to light up and enter the correct combination followed by the “#” button. The green indicator led light will light from left to right (water flow direction), and while the green indicator light is on turn the knob clockwise (right) to open the door.

Opening the Safe Using the Fingerprint:

In the sleep mode, place the preprogrammed fingerprint on the finger recognition scanner. The green indicator led light will light from left to right (water flow direction), and while the green indicator light is on turn the knob clockwise (right) to open the door.

Closing the Safe:

Close the door, and turn the knob counterclockwise (left). The safe is now locked.

Programming the Safe

- ❖ For your safety, please program at least one combination or one fingerprint before start using the safe.
- ❖ **Factory Settings:** Any fingerprint can open the safe, combination 1234, door opening method normal mode.
- ❖ If a fingerprint is programmed then the combination 1234 is no longer valid, if a combination is programmed then any fingerprint can not open the safe.
- ❖ To reset the safe to its factory settings and delete all registered fingerprints and combinations, press and hold the “SET” push button inside the battery compartment at the back of the door for more than 3 seconds until you hear "Initialization Successful" from the safe's built-in Interactive Voice Response. Refer to Fig. 3.
- ❖ Up to 30 fingerprints can be programmed.
- ❖ Up to 10 combinations can be programmed, each consisting of 4 to 12 digits.
- ❖ Follow the built-in Interactive Voice Response for easier programming.



Fig. 3

Programming Your Combination

1. With the safe door open and the touch screen not illuminated, press and release the “SET” button inside the battery compartment at the back of the door (see Fig. 3).
2. The Interactive Voice Response will prompt: "Please enter your fingerprint or password." The LED indicator light will turn fully white.
3. Enter your new combination of 4 to 12 digits followed by the "#" button. The green indicator LED light will illuminate halfway from left to right.
4. Enter the same new combination again followed by the "#" button.
5. The Interactive Voice Response will confirm: "Configuration successful," and the green indicator LED light will fully illuminate, indicating the successful programming of the new combination.
6. Test the new combination with the door open.
7. Repeat the same procedure to program additional combinations.

Note:

1. Up to 10 combinations (4-12 digits) can be programmed. If you've already programmed 10 combinations and want to add another one, pressing and releasing the “SET” button inside the battery compartment will prompt the Interactive Voice Response to say: "Please enter your fingerprint" preventing you from entering another combination.
2. To delete a combination, you must reset the safe and all programmed combinations and fingerprints will be deleted.

Programming Your Fingerprint

1. With the safe door open and the touch screen not illuminated, press and release the "SET" button inside the battery compartment at the back of the door (see Fig. 3).
2. The Interactive Voice Response will prompt: "Please enter your fingerprint or password." The LED indicator light will turn fully white.
3. Place your finger on the fingerprint scanner. The scanner's illuminator light will turn blue a quarter of its length, and the voice prompt will say "Enter it again," indicating you can remove your finger. Repeat this process three more times, with the blue light propagating by a quarter longer each time. When the light turns green and the voice says "Fingerprint configuration successful," your new fingerprint is saved.
4. Test the new fingerprint with the door open.
5. Repeat the same steps to add more fingerprints.
6. If there's an error during the fingerprint configuration, the Interactive Voice Response will say "Fingerprint is invalid, the fingerprint configuration is unsuccessful, Configuration failed."

Note:

1. Up to 30 fingerprints can be programmed. If you've already programmed 30 fingerprints and want to add another one, pressing and releasing the "SET" button inside the battery compartment will prompt the Interactive Voice Response to say: "Please enter your combination" preventing you from entering another fingerprint
2. To delete a fingerprint, you must reset the safe and all programmed combinations and fingerprints will be deleted.

Setting up the Door Opening Method

The safe can be programmed for the door to open in the:

1. Normal Mode which requires the correct combination or the correct fingerprint for the door to open
 2. Security Mode which requires two different combinations or two different fingerprints or one combination and one fingerprint for the door to open.
-
1. With the safe door open and the touch screen not illuminated, press and release the "SET" button inside the battery compartment at the back of the door (see Fig. 3).
 2. The Interactive Voice Response will prompt: "Please enter your fingerprint or password." The LED indicator light will turn fully white.
 3. Press 1# to have the Normal Mode as the opening method. The Interactive Voice Response will prompt: "Single authentication mode"
 4. Press 2# to have the Security Mode as the opening method. The Interactive Voice Response will prompt: "Double authentication mode"

Note:

1. To be able to set up the Security Mode as the opening method, at least two different combinations or two fingerprints or one combination and one fingerprint must be programmed. Otherwise, the Interactive voice response will prompt: "Set up failed".
2. In security mode, when using two combinations to open the safe, both combinations must have the same number of digits if they contain fewer than 6 digits. If the combinations are 6 digits or more, each combination can independently consist of 6 to 12 digits.

WIFI Network Set Up

1. Ensure your mobile phone is connected to a 2.4GHz network and Bluetooth is enabled, and search for the



“Smart Life – Smart Living” application in the Apple Store or the Play Store, download and install it. Once installed, register and launch the Smart Life application. Do not press the "Add Device" button on the application screen yet.

2. With the safe door open and the touch screen inactive, press and release the “SET” button inside the battery compartment located at the back of the door (refer to Fig. 3). The Interactive Voice Response will prompt: "Please enter your fingerprint or password," and the LED indicator light will turn white.
3. Press "5#" on the safe's touch screen to begin pairing with a mobile device. The blue LED indicator of the touch screen on the safe will be illuminated from left to right.
4. On your mobile phone, press the "Add Device" button (refer to Fig. 6) and finish setting up the Smart Life Application.
5. The mobile screen will display the message "Searching for nearby devices." Once the smart safe is detected, the screen will show an image of the safe with the "Add" button next to it (refer to Fig. 7).
6. Press the "Add" button to proceed to the next screen, where you can select the name of your 2.4GHz network and enter its password for the network, then, press "Next" (refer to Fig. 8) to complete the pairing process between the mobile device and the safe.
7. The Interactive Voice Response will prompt: “WIFI configuration successful” and the LED indicator on the safe will turn green from left to right, resembling a flowing water effect, and the mobile screen will display the message "Complete," indicating that the pairing process between the mobile device and the safe is finished (refer to Fig. 8).

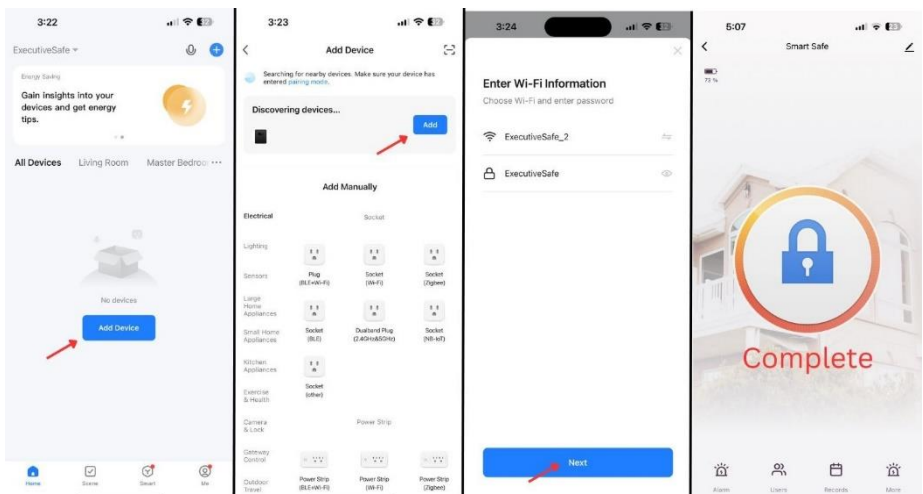

Opening the Safe Remotely:

Remote Access Request:

To remotely open the safe, press anywhere on the keypad to wake up the safe, then press "8#". A request will be sent to the already paired phone to unlock the safe.

Additional App Features:

Battery Monitoring: Checks the battery percentage of the safe.

Remote Unlock: Remotely unlock the safe through an opening request.

Activity Notifications: Receive notifications every time the safe is unlocked.

Alarm Alerts: Get alerted if the alarm is activated or the battery level of your safe is low.

User Management: Assign names to the main combination and user codes to monitor who accesses the safe and when.

Business Model: All unlock methods will be frozen.

Bolt-Down Instructions:

For enhanced security, we strongly recommend bolting your safe.

1. **Select an Ideal Location:** Using the holes provided at the back of the safe, punch through the leather inside the safe. Select a convenient and secure location for your safe. Position the safe in place and use the holes provided at the back to mark the drilling locations on the wall.
2. **Prepare the Mounting Surface:** Move the safe aside and drill a hole in the wall with the appropriate diameter (diameter of the expansion sleeve) and depth (a little longer than the length of the anchor bolt) based on the type of the anchor bolt being used and the mounting surface.
3. **Secure the Safe:** Once the holes are drilled, place the safe back over the holes and install the fastener securely according to the provided instructions.

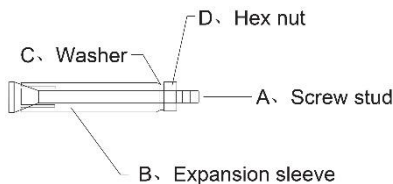

Using a hammer drill, drill a hole the same diameter as the anchor sleeve and a bit longer than the length of the anchor. Clean the hole of any debris.

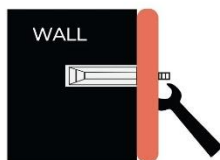

Insert the anchor through both the safe and the pre-drilled hole in the concrete.

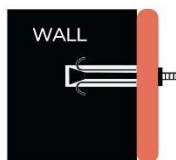

Tighten the nut using a wrench.

**ExecutiveSafe Company Limited
15, Nikitara Street
Nicosia 1080
Cyprus**

**Tel: +357 70 070202
Email: info@executivesafe.com
www.executivesafe.com**